



<b>ACO channel</b>		<b>Page</b>
<b>Introduction</b>	<b>Hygienic design</b>	<b>82</b>
	<b>System overview</b>	<b>83</b>
<b>ACO box channel</b>	<b>Introduction</b>	<b>84</b>
	<b>ACO hygienic box channel - standard articles</b>	<b>86</b>
	<b>ACO hygienic box channel - semi-standard</b>	<b>89</b>
	<b>ACO vinyl box channel - standard articles</b>	<b>90</b>
	<b>ACO vinyl box channel - semi-standard</b>	<b>92</b>
	<b>ACO hygienic cast grating</b>	<b>93</b>
	<b>ACO hygienic ladder grating</b>	<b>94</b>
	<b>ACO mesh grating</b>	<b>98</b>
	<b>ACO hygienic slot cover</b>	<b>100</b>
	<b>Accessories for ACO hygienic box channel</b>	<b>102</b>
	<b>ACO customized box channel</b>	<b>103</b>
	<b>ACO slot channel</b>	<b>Introduction</b>
<b>ACO slot channel - semi-standard</b>		<b>110</b>
<b>ACO customized slot channel</b>		<b>111</b>
<b>ACO modular channel</b>	<b>Introduction</b>	<b>116</b>
	<b>ACO modular box channel 125 - standard articles</b>	<b>120</b>
	<b>Gratings for ACO modular box channel 125</b>	<b>126</b>
	<b>Accessories for ACO modular box channel 125</b>	<b>130</b>
	<b>ACO modular box channel 200 - standard articles</b>	<b>131</b>
	<b>Gratings for ACO modular box channel 200</b>	<b>139</b>
	<b>Accessories for ACO modular box channel 200</b>	<b>142</b>
	<b>ACO modular slot channel 20 - standard articles</b>	<b>143</b>
	<b>Accessories for ACO modular slot channel 20</b>	<b>148</b>
<b>ACO modular channel - semi-standard</b>	<b>149</b>	
<b>ACO design channel</b>	<b>ACO design channel</b>	<b>150</b>
<b>Flow rates</b>	<b>Flow rates and Construction heights</b>	<b>151</b>

**Hygienic design**

ACO offers sustainable, integrated drainage systems which are designed to protect your business, the environment and ultimately public health. Our aim is to constantly improve every aspect of safety, hygiene and functional performance.

We believe that our systems and services are truly unique, delivering unparalleled benefits to everyone involved in project delivery or subsequent operation.

ACO hygienic drainage fulfils stringent hygienic requirements to prevent harmful bacterial contamination. We apply the relevant hygienic design principles reserved for food contact surfaces EN 1672, EN ISO 14159, EHEDG document to the channel design.

**ACO channel hygienic features:**

- Fully drainable
- Internal radii equal or larger than 3 mm
- Hygienic joints
- Edge infill
- Stainless steel grade min. AISI 304
- Fully pickled and passivated

ACO channel

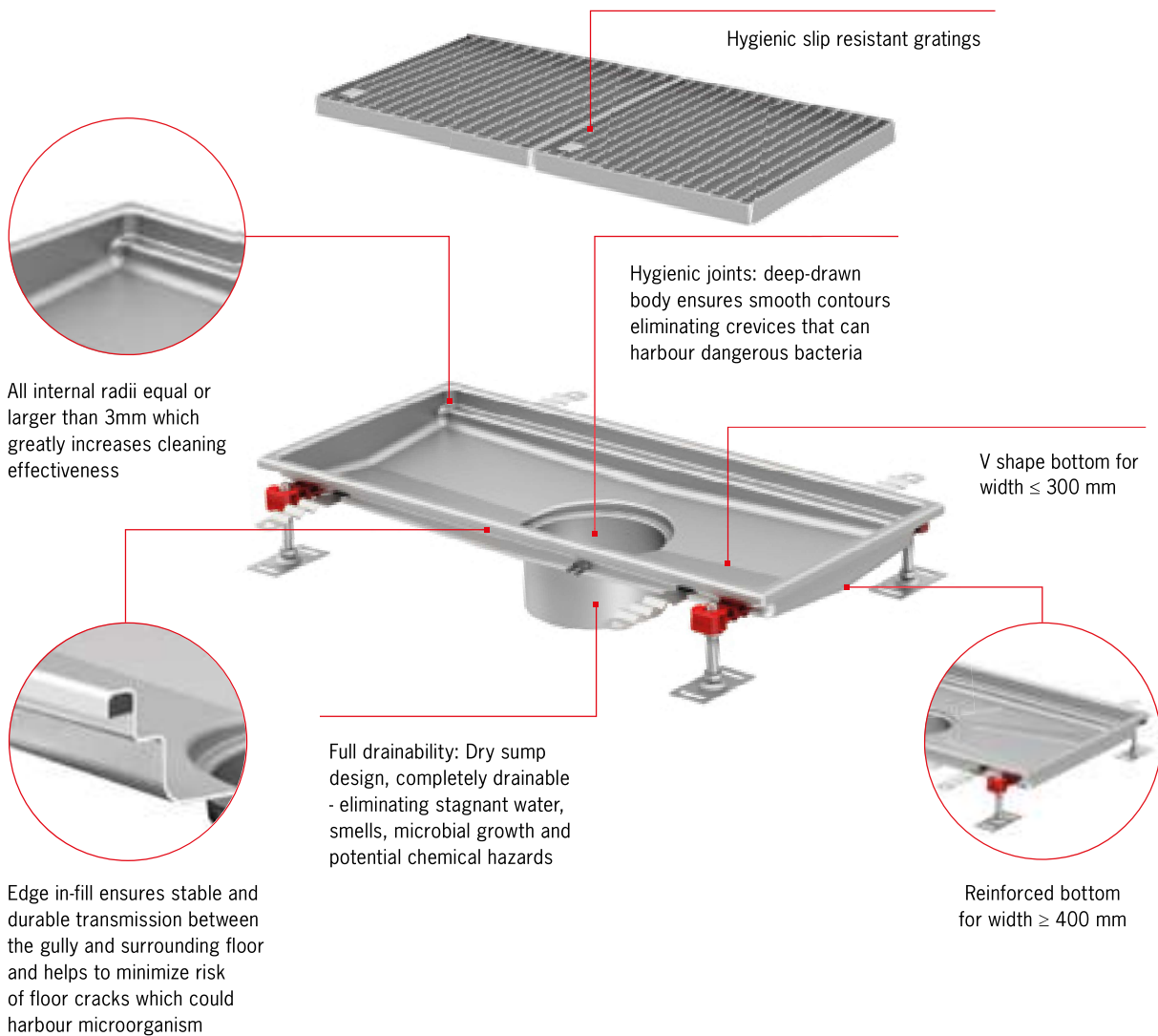

All internal radii equal or larger than 3mm which greatly increases cleaning effectiveness

Edge in-fill ensures stable and durable transmission between the gully and surrounding floor and helps to minimize risk of floor cracks which could harbour microorganism

Full drainability: Dry sump design, completely drainable - eliminating stagnant water, smells, microbial growth and potential chemical hazards

Hygienic joints: deep-drawn body ensures smooth contours eliminating crevices that can harbour dangerous bacteria

V shape bottom for width  $\leq 300\text{ mm}$

Reinforced bottom for width  $\geq 400\text{ mm}$

**System overview**

**ACO channel**



**ACO box channel**



**ACO slot channel**

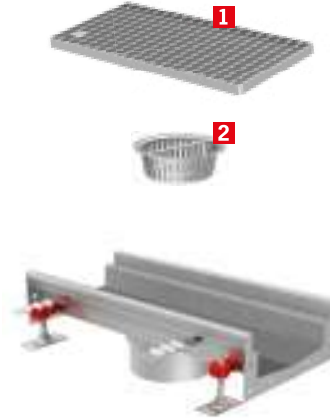

**ACO modular box channel**

- 1** Gratings
- 2** Silt basket
- 3** Friction ring
- 4** Foul air trap
- 5** Foul air trap support
- 6** ACO gully



**ACO gully  
with accessories**

ACO channel



## Introduction

### ACO box channel portfolio

---

The ACO box channel range includes channels for all common applications and all common floor types (concrete, tiles, resin or vinyl). The ACO box channel portfolio is designed with respect to hygienic design requirements. Selecting a channel from the range is easy.

The unique variability of the whole portfolio makes it easy to choose a channel that suits a customer's specific needs. Channel length, depth and outlet position are just a few of the parameters which can be varied and, regardless of the variations specified, there is no impact on delivery lead times.

### ACO box channel ordering

---

The dimensions of the ACO box channel can be easily specified in respect of project requirements. To specify the channel please use the Customization template (see page 103) which will help you to identify the information you need, or contact our Sales/Technical department.

ACO box channels with fixed dimensions are also available. These dimensions are a selection of most frequently sold ACO box channels. Please see page 85 where you can find the overview.

### ACO box channel customization

---

In addition all ACO box channels can be designed with:

- Special outlet position
- Special depth
- Special slope
- Special channel width
- L-shape and T-shape lay out
- Special side inlets

To ask for customised ACO box channel, please contact our Sales/technical department. Please take into consideration that ACO channel customization could decrease the number of hygienic design features.

**ACO box channel system overview**

---

**ACO box channel - fixed height solution**

---



**ACO hygienic box channel**  
**Standard edge**

**ACO hygienic box channel**  
**Extended edge**

**ACO vinyl box channel**

**ACO box channel - telescopic solution**

---



**ACO hygienic box channel**  
**Standard edge**

**ACO hygienic box channel**  
**Extended edge**

**ACO vinyl box channel**



**ACO hygienic gully**  
**with accessories**

**ACO hygienic box channel - standard articles**

**Product information**

The dimensions of the ACO hygienic box channel for concrete, tiles and resin floor can be easily specified in respect of project requirements or easily chosen from predefined fixed dimensions.

**HygieneFirst features**

- Hygienic design following EN 1672, EN ISO 14159 and EHEDG document No. 8, 13 and 44
- Available in 1.4301 (304) or 1.4404 (316L) grades of stainless steel
- Material thickness 1.5 mm
- Fully removable and easily cleanable stainless steel foul air trap (FAT)
- Rubber edge infill
- Fully pickled and passivated
- Minimal longitudinal slope 1%
- Min. sectional slope 5°
- Material thickness 1.5 mm
- Hygienic gratings with slip resistance available
- Protective cover available. See page 224 for more details
- Tested and certified according to EN 1253
- V-shape bottom for width < 300 mm
- Reinforced bottom for width > 400 mm
- Outlet without deformation
- Easy and secure telescopic connection with gully
- Adjustable EasyFix levelling feet 60-110 mm
- Anchors for fixing in concrete

**Order information**

**Standard edge**

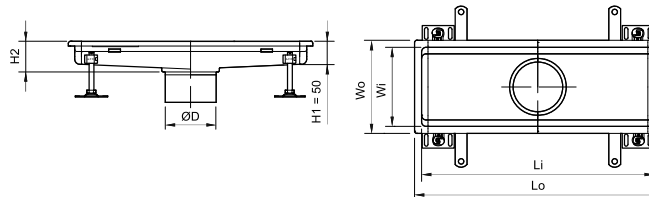

**Extended edge**

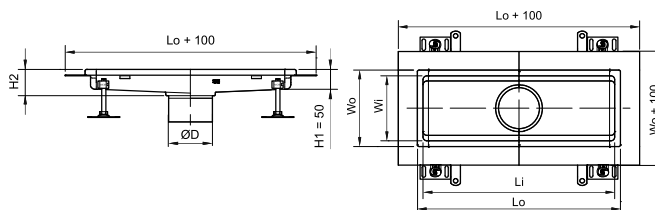

Wo [mm]	Wi [mm]	Channel dimensions		H2 [mm]	øD [mm]	Gully	Material	Standard edge	Extended edge
		Lo [mm]	Li [mm]					Item number	Item number
200	170	530	500	60	125	ACO hygienic gully 142	1.4301	<b>416584</b>	<b>416680</b>
		530	500				1.4404	<b>416602</b>	<b>416698</b>
		830	800				1.4301	<b>416585</b>	<b>416681</b>
		830	800				1.4404	<b>416603</b>	<b>416699</b>
		1030	1000				1.4301	<b>416586</b>	<b>416682</b>
		1030	1000				1.4404	<b>416604</b>	<b>416700</b>
		1230	1200				1.4301	<b>416587</b>	<b>416683</b>
		1230	1200				1.4404	<b>416605</b>	<b>416701</b>
		1530	1500				1.4301	<b>416588</b>	<b>416684</b>
		1530	1500				1.4404	<b>416606</b>	<b>416702</b>
		2030	2000				1.4301	<b>416589</b>	<b>416685</b>
		2030	2000				1.4404	<b>416607</b>	<b>416703</b>

**Order information**

Wo [mm]	Wi [mm]	Channel dimensions		H2 [mm]	øD [mm]	Gully	Material	Standard edge	Extended edge	
		Lo [mm]	Li [mm]					Item number	Item number	
200	170	530	500	60	142	ACO hygienic gully 157	1.4301	<b>416590</b>	<b>416686</b>	
		530	500					1.4404	<b>416608</b>	<b>416704</b>
		830	800					1.4301	<b>416591</b>	<b>416687</b>
		830	800					1.4404	<b>416609</b>	<b>416705</b>
		1030	1000					1.4301	<b>416592</b>	<b>416688</b>
		1030	1000					1.4404	<b>416610</b>	<b>416706</b>
		1230	1200					1.4301	<b>416593</b>	<b>416689</b>
		1230	1200					1.4404	<b>416611</b>	<b>416707</b>
		1530	1500					1.4301	<b>416594</b>	<b>416690</b>
		1530	1500					1.4404	<b>416612</b>	<b>416708</b>
		2030	2000					1.4301	<b>416595</b>	<b>416691</b>
		2030	2000					1.4404	<b>416613</b>	<b>416709</b>
300	270	330	300	55	142	ACO hygienic gully 157	1.4301	<b>416614</b>	<b>416710</b>	
		330	300	60				1.4404	<b>416628</b>	<b>416724</b>
		630	600					1.4301	<b>416615</b>	<b>416711</b>
		630	600	60				1.4404	<b>416629</b>	<b>416725</b>
		1030	1000					1.4301	<b>416616</b>	<b>416712</b>
		1030	1000	60				1.4404	<b>416630</b>	<b>416726</b>
		1530	1500					1.4301	<b>416617</b>	<b>416713</b>
		1530	1500	60				1.4404	<b>416631</b>	<b>416727</b>
		2030	2000					1.4301	<b>416618</b>	<b>416714</b>
		2030	2000	60				1.4404	<b>416632</b>	<b>416728</b>
		3030	3000					1.4301	<b>416619</b>	<b>416715</b>
		3030	3000	70				1.4404	<b>416633</b>	<b>416729</b>
		4030	4000					1.4301	<b>416620</b>	<b>416716</b>
		4030	4000	80				1.4404	<b>416634</b>	<b>416730</b>
300	270	330	300		55	200	ACO hygienic gully 218	1.4301	<b>416621</b>	<b>416717</b>
		330	300	60	1.4404				<b>416635</b>	<b>416731</b>
		630	600		1.4301				<b>416622</b>	<b>416718</b>
		630	600	60	1.4404				<b>416636</b>	<b>416732</b>
		1030	1000		1.4301				<b>416623</b>	<b>416719</b>
		1030	1000	60	1.4404				<b>416637</b>	<b>416733</b>
		1530	1500		1.4301				<b>416624</b>	<b>416720</b>
		1530	1500	60	1.4404				<b>416638</b>	<b>416734</b>
		2030	2000		1.4301				<b>416625</b>	<b>416721</b>
		2030	2000	60	1.4404				<b>416639</b>	<b>416735</b>
		3030	3000		1.4301				<b>416626</b>	<b>416722</b>
		3030	3000	70	1.4404				<b>416640</b>	<b>416736</b>
		4030	4000		1.4301				<b>416627</b>	<b>416723</b>
		4030	4000	80	1.4404				<b>416641</b>	<b>416737</b>
400	370	430	400		60	142	ACO hygienic gully 157	1.4301	<b>416642</b>	<b>416738</b>
		430	400	1.4404					<b>416648</b>	<b>416744</b>
		630	600	1.4301					<b>416643</b>	<b>416739</b>
		630	600	1.4404					<b>416649</b>	<b>416745</b>
		830	800	1.4301					<b>416644</b>	<b>416740</b>
		830	800	1.4404					<b>416650</b>	<b>416746</b>
400	370	430	400	60	200	ACO hygienic gully 218	1.4301	<b>416645</b>	<b>416741</b>	
		430	400					1.4404	<b>416651</b>	<b>416747</b>
		630	600					1.4301	<b>416646</b>	<b>416742</b>
		630	600					1.4404	<b>416652</b>	<b>416748</b>
		830	800					1.4301	<b>416647</b>	<b>416743</b>
		830	800					1.4404	<b>416653</b>	<b>416749</b>

ACO channel

**ACO box channel**  
**ACO hygienic box channel - standard articles**

ACO channel

Wo [mm]	Wi [mm]	Channel dimensions		H2 [mm]	øD [mm]	Gully	Material	Standard edge	Extended edge
		Lo [mm]	Li [mm]					Item number	Item number
500	470	530	500	65	142	ACO hygienic gully 157	1.4301	<b>416654</b>	<b>416750</b>
		530	500				1.4404	<b>416660</b>	<b>416756</b>
		830	800				1.4301	<b>416655</b>	<b>416751</b>
		830	800				1.4404	<b>416661</b>	<b>416757</b>
		1030	1000				1.4301	<b>416656</b>	<b>416752</b>
		1030	1000				1.4404	<b>416662</b>	<b>416758</b>
		530	500				1.4301	<b>416657</b>	<b>416753</b>
500	470	530	500	65	200	ACO hygienic gully 218	1.4404	<b>416663</b>	<b>416759</b>
		830	800				1.4301	<b>416658</b>	<b>416754</b>
		830	800				1.4404	<b>416664</b>	<b>416760</b>
		1030	1000				1.4301	<b>416659</b>	<b>416755</b>
		1030	1000				1.4404	<b>416665</b>	<b>416761</b>
		630	600				1.4301	<b>416666</b>	<b>416762</b>
600	570	630	600	70	200	ACO hygienic gully 218	1.4404	<b>416669</b>	<b>416765</b>
		930	900				1.4301	<b>416667</b>	<b>416763</b>
		930	900				1.4404	<b>416670</b>	<b>416766</b>
		1230	1200				1.4301	<b>416668</b>	<b>416764</b>
		1230	1200				1.4404	<b>416671</b>	<b>416767</b>
		630	600				1.4301	<b>416666</b>	<b>416762</b>
800	770	830	800	80	200	ACO hygienic gully 218	1.4301	<b>416672</b>	<b>416768</b>
							1.4404	<b>416673</b>	<b>416769</b>



**ACO hygienic box channel - semi-standard**

**Product information**

The dimensions of the ACO hygienic box channel for concrete, tiles and resin floor can be easily specified in respect of project requirements.

**HygieneFirst features**

- Hygienic design following EN 1672, EN ISO 14159 and EHEDG document No. 8, 13 and 44
- Available in 1.4301 (304) or 1.4404 (316L) grades of stainless steel
- Fully removable and easily cleanable stainless steel foul air trap (FAT)
- Rubber edge infill
- Fully pickled and passivated
- Sectional slope of the channel bottom 5°
- Longitudinal slope of the channel bottom 1-5 %
- Material thickness 1.5 mm
- Hygienic gratings with slip resistance available
- Protective cover available. See page 224 for more details
- Tested and certified according to EN 1253
- V-shape bottom for width < 300 mm
- Reinforced bottom for width > 400 mm
- Length - up to customer request
- Height - variable 50-200
- Outlet position variable in longitudinal axis
- Standardized widths
- Easy and secure telescopic connection with gully
- Adjustable EasyFix levelling feet 60-110 mm
- Anchors for fixing in concrete

**Order information**

**Standard edge**

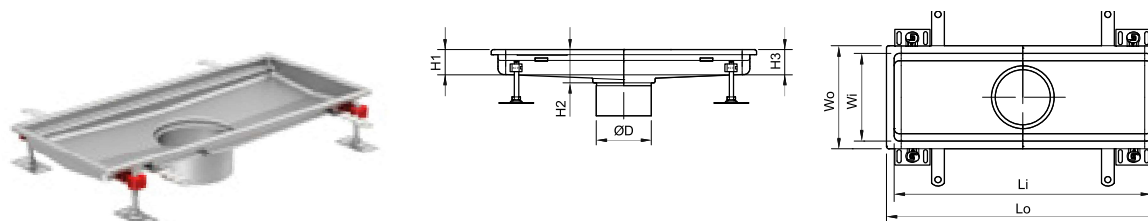

**Extended edge**

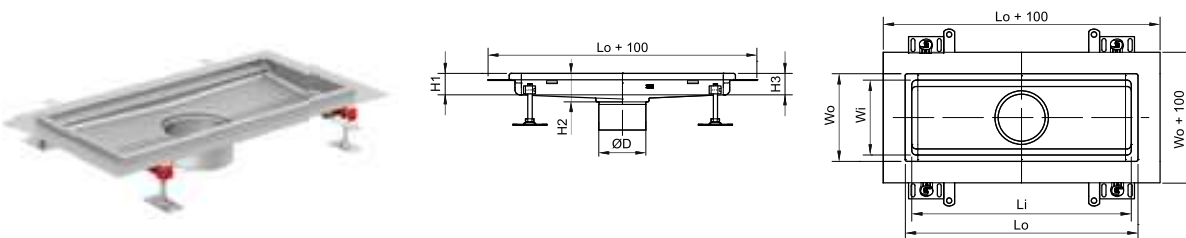

External (overall) width Wo [mm]	Internal (grating) width Wi [mm]	Length of channel Lo	Height at outlet of channel H2	Height at end of channel H1 and H3
200	170	Variable *	50-200	50, 80, 110, 140
300	270			
400	370			
500	470			
600	570			
800	770			

\* Long channels over 6m are standard divided in 6m sections with transport joints.

In case of one piece channel requirement, channels have to be welded on site. Please contact our Sales/Technical department.

**ACO vinyl box channel - standard articles**

**Product information**

The dimensions of the ACO vinyl box channel can be specified in respect of project requirements or easily chosen from predefined fixed dimensions.

- Fully compliant to EN 1253
- Available in 1.4301 (304) or 1.4404 (316L) grades of stainless steel, pickled and passivated
- Material thickness 1.5 mm
- Easy and secure telescopic connection with gully
- Adjustable EasyFix levelling feet 60-110 mm
- Anchors for fixing in concrete
- Protective cover available.  
See page 224 for more details

**Order information**

**Vinyl edge**

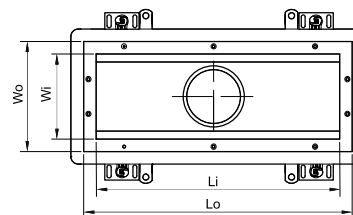
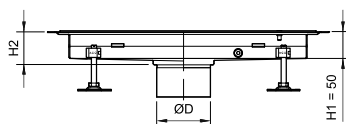

Wo [mm]	Wi [mm]	Channel dimensions		H2 [mm]	øD [mm]	Gully	Material	Vinyl edge
		Lo [mm]	Li [mm]					Item number
220	170	550	500	60	125	ACO hygienic gully 142	1.4301	<b>413358</b>
		550	500				1.4404	<b>413376</b>
		850	800				1.4301	<b>413359</b>
		850	800				1.4404	<b>413377</b>
		1050	1000				1.4301	<b>413360</b>
		1050	1000				1.4404	<b>413378</b>
		1250	1200				1.4301	<b>413361</b>
		1250	1200				1.4404	<b>413379</b>
		1550	1500				1.4301	<b>413362</b>
		1550	1500				1.4404	<b>413380</b>
		2050	2000				1.4301	<b>413363</b>
		2050	2000				1.4404	<b>413381</b>
220	170	550	500	60	142	ACO hygienic gully 157	1.4301	<b>413364</b>
		550	500				1.4404	<b>413382</b>
		850	800				1.4301	<b>413365</b>
		850	800				1.4404	<b>413383</b>
		1050	1000				1.4301	<b>413366</b>
		1050	1000				1.4404	<b>413384</b>
		1250	1200				1.4301	<b>413367</b>
		1250	1200				1.4404	<b>413385</b>
		1550	1500				1.4301	<b>413368</b>
		1550	1500				1.4404	<b>413386</b>
		2050	2000				1.4301	<b>413369</b>
		2050	2000				1.4404	<b>413387</b>

**ACO box channel**  
**ACO vinyl box channel - standard articles**

Wo [mm]	Wi [mm]	Channel dimensions		H2 [mm]	øD [mm]	Gully	Material	Vinyl edge
		Lo [mm]	Li [mm]					Item number
320	270	350	300	60	142	ACO hygienic gully 157	1.4301	<b>413388</b>
		350	300				1.4404	<b>413402</b>
		650	600				1.4301	<b>413389</b>
		650	600				1.4404	<b>413403</b>
		1050	1000				1.4301	<b>413390</b>
		1050	1000				1.4404	<b>413404</b>
		1550	1500				1.4301	<b>413391</b>
		1550	1500				1.4404	<b>413405</b>
		2050	2000				1.4301	<b>413392</b>
		2050	2000				1.4404	<b>413406</b>
		3050	3000	1.4301			<b>413393</b>	
		3050	3000	1.4404			<b>413407</b>	
		4050	4000	1.4301			<b>413394</b>	
		4050	4000	1.4404			<b>413408</b>	
320	270	350	300	60	200	ACO hygienic gully 218	1.4301	<b>413395</b>
		350	300				1.4404	<b>413409</b>
		650	600				1.4301	<b>413396</b>
		650	600				1.4404	<b>413410</b>
		1050	1000				1.4301	<b>413397</b>
		1050	1000				1.4404	<b>413411</b>
		1550	1500				1.4301	<b>413398</b>
		1550	1500				1.4404	<b>413412</b>
		2050	2000				1.4301	<b>413399</b>
		2050	2000				1.4404	<b>413413</b>
		3050	3000	1.4301			<b>413400</b>	
		3050	3000	1.4404			<b>413414</b>	
		4050	4000	1.4301			<b>413401</b>	
		4050	4000	1.4404			<b>413415</b>	
420	370	450	400	60	142	ACO hygienic gully 157	1.4301	<b>413416</b>
		450	400				1.4404	<b>413422</b>
		650	600				1.4301	<b>413417</b>
		650	600				1.4404	<b>413423</b>
		850	800				1.4301	<b>413418</b>
		850	800				1.4404	<b>413424</b>
420	370	450	400	60	200	ACO hygienic gully 218	1.4301	<b>413419</b>
		450	400				1.4404	<b>413425</b>
		650	600				1.4301	<b>413420</b>
		650	600				1.4404	<b>413426</b>
		850	800				1.4301	<b>413421</b>
		850	800				1.4404	<b>413427</b>
520	470	530	500	65	142	ACO hygienic gully 157	1.4301	<b>413428</b>
		530	500				1.4404	<b>413434</b>
		830	800				1.4301	<b>413429</b>
		830	800				1.4404	<b>413435</b>
		1030	1000				1.4301	<b>413430</b>
		1030	1000				1.4404	<b>413436</b>
520	470	550	500	65	200	ACO hygienic gully 218	1.4301	<b>413431</b>
		550	500				1.4404	<b>413437</b>
		850	800				1.4301	<b>413432</b>
		850	800				1.4404	<b>413438</b>
		1050	1000				1.4301	<b>413433</b>
		1050	1000				1.4404	<b>413439</b>
620	570	650	600	70	200	ACO hygienic gully 218	1.4301	<b>413440</b>
		650	600				1.4404	<b>413443</b>
		950	900				1.4301	<b>413441</b>
		950	900				1.4404	<b>413444</b>
		1250	1200				1.4301	<b>413442</b>
		1250	1200				1.4404	<b>413445</b>
820	770	850	800	80	200	ACO hygienic gully 218	1.4301	<b>413446</b>
							1.4404	<b>413447</b>

ACO channel

**ACO vinyl box channel - semi-standard**

**Product information**

The dimensions of the ACO vinyl box channel can be easily specified in respect of project requirements.

- Fully compliant to EN 1253
- Available in 1.4301 (304) or 1.4404 (316L) grades of stainless steel, pickled and passivated
- Material thickness 1.5 mm
- Height variable 50-200 mm
- Length – up to customer request
- Standardized widths
- Outlet position central or variable in longitudinal axis
- Longitudinal slopes of the channel bottom 1-5 %
- Adjustable EasyFix levelling feet 60-110 mm
- Anchors for fixing in concrete
- Protective cover available. See page 224 for more details

**Order information**

Vinyl edge

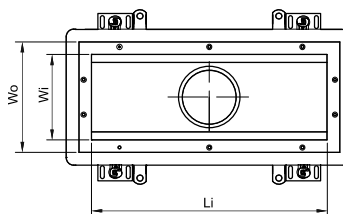
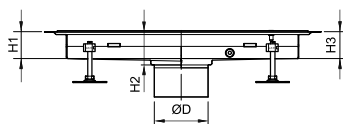

External (overall) width Wo [mm]	Internal (grating) width Wi [mm]	Length of channel Li	Height at outlet of channel H2	Height at end of channel H1 and H3
230	170	Variable *	50-200	50, 80, 110, 140
330	270			
430	370			
530	470			
630	570			
830	870			

\* Long channels over 6m are standard divided in 6m sections with transport joints.

In case of requirements one piece channel, channels have to be welded on site. Please contact our Sales/Technical department.

**ACO hygienic cast grating**

**Product information**

**HygieneFirst features**

- Hygienic design following EN 1672, EN ISO 14159 and EHEDG document No. 8, 13 and 44
- Available in 1.4301 (304) grade of stainless steel
- Fully pickled and passivated
- Electropolished surface
- Frameless design for optimum drainability and cleanliness
- Tested and certified according to EN 1253
- Range of gratings suitable for load class M 125 (EN 1253)
- Slip resistant
  - Low potential for slip according to BS 7976-2,
  - R13 according to DIN 51130



**Order information - Load class M 125**

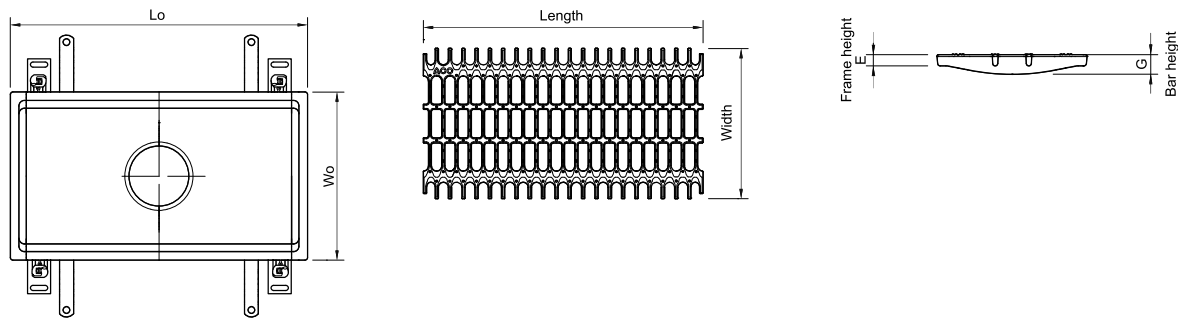

Channel dimension		Grating dimension				Material	Item number	Quantity to fill channel
Wo [mm]	Lo [mm]	Frame height E [mm]	Bar height G [mm]	Width [mm]	Length [mm]			
200	530	20	30	168	499	1.4301	<b>416947</b>	1
	830	20	30	168	398	1.4301	<b>416948</b>	2
	1030	20	30	168	499	1.4301	<b>416947</b>	2
	1230	20	30	168	398	1.4301	<b>416948</b>	3
	1530	20	30	168	499	1.4301	<b>416947</b>	3
	2030	20	30	168	499	1.4301	<b>416947</b>	4
300	330	20	30	268	298	1.4301	<b>416946</b>	1
	630	20	30	268	298	1.4301	<b>416946</b>	2
	1030	20	30	268	499	1.4301	<b>416945</b>	2
	1530	20	30	268	499	1.4301	<b>416945</b>	3
	2030	20	30	268	499	1.4301	<b>416945</b>	4
	3030	20	30	268	499	1.4301	<b>416945</b>	6
	4030	20	30	268	499	1.4301	<b>416945</b>	8



**ACO hygienic ladder grating**

**Product information**

**HygieneFirst features**

- Hygienic design following EN 1672, EN ISO 14159 and EHEDG document No. 8, 13 and 44
- Fully pickled and passivated
- Electropolished surface
- Registered logo design allows for easy manipulation during cleaning



- Range of gratings suitable for load classes R 50, M 125 and N 250 (EN 1253)
- Tested and certified according to NSF International
- High flow capacity
- Rounded corners
- Slip resistant
  - Low potential for slip according to BS 7976-2,
  - R11 according to DIN 51130



ACO channel

**Order information - Load class R 50**

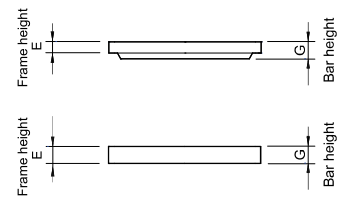
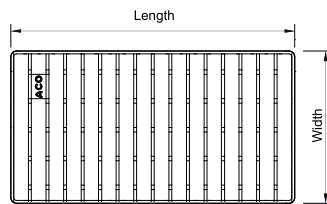
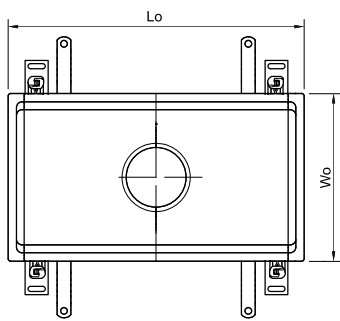

Channel dimension		Grating dimension				Material	Item number	Quantity to fill channel
Wo [mm]	Lo [mm]	Frame height E [mm]	Bar height G [mm]	Width [mm]	Length [mm]			
200	530	20	20	168	499	1.4301	<b>416802</b>	1
						1.4404	<b>416803</b>	
	830	20	20	168	398	1.4301	<b>416808</b>	2
						1.4404	<b>416809</b>	
	1030	20	20	168	499	1.4301	<b>416802</b>	2
						1.4404	<b>416803</b>	
	1230	20	20	168	398	1.4301	<b>416808</b>	3
						1.4404	<b>416809</b>	
	1530	20	20	168	499	1.4301	<b>416802</b>	3
						1.4404	<b>416803</b>	
	2030	20	20	168	499	1.4301	<b>416802</b>	4
						1.4404	<b>416803</b>	

Channel dimension		Grating dimension				Material	Item number	Quantity to fill channel
Wo [mm]	Lo [mm]	Frame height E [mm]	Bar height G [mm]	Width [mm]	Length [mm]			
300	330	20	20	268	298	1.4301	<b>416812</b>	1
						1.4404	<b>416813</b>	
	630	20	20	268	298	1.4301	<b>416812</b>	2
						1.4404	<b>416813</b>	
	1030	20	20	268	499	1.4301	<b>416814</b>	2
						1.4404	<b>416815</b>	
	1530	20	20	268	499	1.4301	<b>416814</b>	3
						1.4404	<b>416815</b>	
	2030	20	20	268	499	1.4301	<b>416814</b>	4
						1.4404	<b>416815</b>	
	3030	20	20	268	499	1.4301	<b>416814</b>	6
						1.4404	<b>416815</b>	
	4030	20	20	268	499	1.4301	<b>416814</b>	8
						1.4404	<b>416815</b>	
400	430	30	30	368	398	1.4301	<b>416820</b>	1
						1.4404	<b>416821</b>	
	630	30	30	368	598	1.4301	<b>416822</b>	1
						1.4404	<b>416823</b>	
	830	30	30	368	398	1.4301	<b>416820</b>	2
						1.4404	<b>416821</b>	
500	530	30	30	468	499	1.4301	<b>416828</b>	1
						1.4404	<b>416829</b>	
	830	30	30	468	398	1.4301	<b>416830</b>	2
						1.4404	<b>416831</b>	
	1030	30	30	468	499	1.4301	<b>416828</b>	2
						1.4404	<b>416829</b>	
600	630	30	30	568	298	1.4301	<b>416838</b>	2
						1.4404	<b>416839</b>	
	930	30	30	568	298	1.4301	<b>416838</b>	3
						1.4404	<b>416839</b>	
	1230	30	30	568	298	1.4301	<b>416838</b>	4
						1.4404	<b>416839</b>	
800	830	30	30	768	398	1.4301	<b>416842</b>	2
						1.4404	<b>416843</b>	

ACO channel

**Order information - Load class M 125**

ACO channel

Channel dimension		Grating dimension				Material	Item number	Quantity to fill channel
Wo [mm]	Lo [mm]	Frame height E [mm]	Bar height G [mm]	Width [mm]	Length [mm]			
200	530	20	30	168	499	1.4301	<b>416804</b>	1
						1.4404	<b>416805</b>	
	830	20	30	168	398	1.4301	<b>416810</b>	2
						1.4404	<b>416811</b>	
	1030	20	30	168	499	1.4301	<b>416804</b>	2
						1.4404	<b>416805</b>	
	1230	20	30	168	398	1.4301	<b>416810</b>	3
						1.4404	<b>416811</b>	
	1530	20	30	168	499	1.4301	<b>416804</b>	3
						1.4404	<b>416805</b>	
	2030	20	30	168	499	1.4301	<b>416804</b>	4
						1.4404	<b>416805</b>	
300	330	20	30	268	298	1.4301	<b>416816</b>	1
						1.4404	<b>416817</b>	
	630	20	30	268	298	1.4301	<b>416816</b>	2
						1.4404	<b>416817</b>	
	1030	20	30	268	499	1.4301	<b>416818</b>	2
						1.4404	<b>416819</b>	
	1530	20	30	268	499	1.4301	<b>416818</b>	3
						1.4404	<b>416819</b>	
	2030	20	30	268	499	1.4301	<b>416818</b>	4
						1.4404	<b>416819</b>	
	3030	20	30	268	499	1.4301	<b>416818</b>	6
						1.4404	<b>416819</b>	
4030	20	30	268	499	1.4301	<b>416818</b>	8	
					1.4404	<b>416819</b>		
400	430	30	30	368	398	1.4301	<b>416824</b>	1
						1.4404	<b>416825</b>	
	630	30	30	368	598	1.4301	<b>416826</b>	1
						1.4404	<b>416827</b>	
	830	30	30	368	398	1.4301	<b>416824</b>	2
						1.4404	<b>416825</b>	
500	530	30	30	468	499	1.4301	<b>416832</b>	1
						1.4404	<b>416833</b>	
	830	30	30	468	398	1.4301	<b>416834</b>	2
						1.4404	<b>416835</b>	
	1030	30	30	468	499	1.4301	<b>416832</b>	2
						1.4404	<b>416833</b>	

**Order information - Load class N 250**

Channel dimension		Grating dimension				Material	Item number	Quantity to fill channel
Wo [mm]	Lo [mm]	Frame height E [mm]	Bar height G [mm]	Width [mm]	Length [mm]			
200	530	20	30	168	499	1.4301	<b>416844</b>	1
						1.4404	<b>416845</b>	
	830	20	30	168	398	1.4301	<b>416846</b>	2
						1.4404	<b>416847</b>	
	1030	20	30	168	499	1.4301	<b>416844</b>	2
						1.4404	<b>416845</b>	
	1230	20	30	168	398	1.4301	<b>416846</b>	3
						1.4404	<b>416847</b>	
	1530	20	30	168	499	1.4301	<b>416844</b>	3
						1.4404	<b>416845</b>	
	2030	20	30	168	499	1.4301	<b>416844</b>	4
						1.4404	<b>416845</b>	
300	330	20	30	268	298	1.4301	<b>416850</b>	1
						1.4404	<b>416851</b>	
	630	20	30	268	298	1.4301	<b>416850</b>	2
						1.4404	<b>416851</b>	
	1030	20	30	268	499	1.4301	<b>416848</b>	2
						1.4404	<b>416849</b>	
	1530	20	30	268	499	1.4301	<b>416848</b>	3
						1.4404	<b>416849</b>	
	2030	20	30	268	499	1.4301	<b>416848</b>	4
						1.4404	<b>416849</b>	
	3030	20	30	268	499	1.4301	<b>416848</b>	6
						1.4404	<b>416849</b>	
	4030	20	30	268	499	1.4301	<b>416848</b>	8
						1.4404	<b>416849</b>	

ACO channel

**ACO mesh grating**

**Product information**

- ACO mesh grating with slip resistant finish
- Tested and certified according to EN 1253
- Range of gratings suitable to load class L 15 (EN 1253)
- Surface - electropolished
- High flow capacity of grates
- Rounded corners
- Slip resistant
- Slip resistant low potential for slip according to BS 7976-2,
- R11 according to DIN 51130

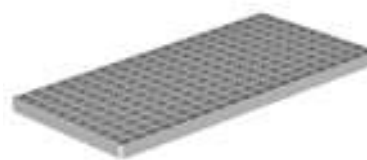

**Order information - Load class L 15**

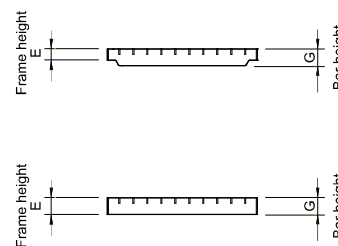
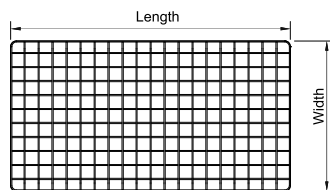
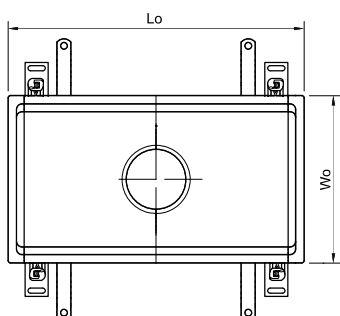

Channel dimension		Grating dimension				Material	Item number	Quantity to fill channel
Wo [mm]	Lo [mm]	Frame height E [mm]	Bar height G [mm]	Width [mm]	Length [mm]			
200	530	20	30	168	499	1.4301	<b>416860</b>	1
						1.4404	<b>416861</b>	
	830	20	30	168	398	1.4301	<b>416862</b>	2
						1.4404	<b>416863</b>	
	1030	20	30	168	499	1.4301	<b>416860</b>	2
						1.4404	<b>416861</b>	
	1230	20	30	168	398	1.4301	<b>416862</b>	3
						1.4404	<b>416863</b>	
	1530	20	30	168	499	1.4301	<b>416860</b>	3
						1.4404	<b>416861</b>	
	2030	20	30	168	499	1.4301	<b>416860</b>	4
						1.4404	<b>416861</b>	



Channel dimension		Grating dimension				Material	Item number	Quantity to fill channel
Wo [mm]	Lo [mm]	Frame height E [mm]	Bar height G [mm]	Width [mm]	Length [mm]			
300	330	20	30	268	298	1.4301	<b>416864</b>	1
						1.4404	<b>416865</b>	
	630	20	30	268	298	1.4301	<b>416864</b>	2
						1.4404	<b>416865</b>	
	1030	20	30	268	499	1.4301	<b>416866</b>	2
						1.4404	<b>416867</b>	
	1530	20	30	268	499	1.4301	<b>416866</b>	3
						1.4404	<b>416867</b>	
	2030	20	30	268	499	1.4301	<b>416866</b>	4
						1.4404	<b>416867</b>	
3030	20	30	268	499	1.4301	<b>416866</b>	6	
					1.4404	<b>416867</b>		
4030	20	30	268	499	1.4301	<b>416866</b>	8	
					1.4404	<b>416867</b>		
400	430	30	30	368	398	1.4301	<b>416868</b>	1
						1.4404	<b>416869</b>	
	630	30	30	368	598	1.4301	<b>416870</b>	1
						1.4404	<b>416871</b>	
830	30	30	368	398	1.4301	<b>416868</b>	2	
					1.4404	<b>416869</b>		
500	530	30	30	468	499	1.4301	<b>416872</b>	1
						1.4404	<b>416873</b>	
	830	30	30	468	398	1.4301	<b>416874</b>	2
						1.4404	<b>416875</b>	
1030	30	30	468	499	1.4301	<b>416872</b>	2	
					1.4404	<b>416873</b>		
600	630	30	30	568	298	1.4301	<b>416876</b>	2
						1.4404	<b>416877</b>	
	930	30	30	568	298	1.4301	<b>416876</b>	3
						1.4404	<b>416877</b>	
1230	30	30	568	298	1.4301	<b>416876</b>	4	
					1.4404	<b>416877</b>		
800	830	30	30	768	398	1.4301	<b>416878</b>	2
						1.4404	<b>416879</b>	

ACO channel

**ACO hygienic slot cover**

**Product information**

- Hygienic design following EN 1672, EN ISO 14159 and EHEDG document No. 8, 13 and 44
- Fully pickled and passivated
- Sandblasted surface
- Range of gratings suitable for load classes R 50, M 125 and N 250 (EN 1253)
- Rounded corners
- Slip resistant
  - Low potential for slip according to BS 7976-2,
  - R11 according to DIN 51130



**Order information - Load class R 50**

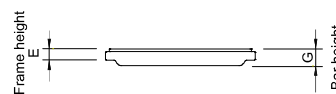
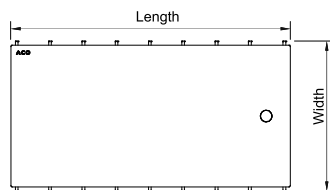
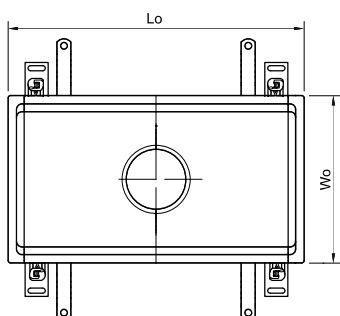

ACO channel

Channel dimension		Grating dimension				Material	Item number	Quantity to fill channel
Wo [mm]	Lo [mm]	Frame height E [mm]	Bar height G [mm]	Width [mm]	Length [mm]			
200	530	20	30	168	499	1.4301	<b>445756</b>	1
						1.4404	<b>445757</b>	
	830	20	30	168	398	1.4301	<b>445762</b>	2
						1.4404	<b>445763</b>	
	1030	20	30	168	499	1.4301	<b>445756</b>	2
						1.4404	<b>445757</b>	
	1230	20	30	168	398	1.4301	<b>445762</b>	3
						1.4404	<b>445763</b>	
	1530	20	30	168	499	1.4301	<b>445756</b>	3
						1.4404	<b>445757</b>	
	2030	20	30	168	499	1.4301	<b>445756</b>	4
						1.4404	<b>445757</b>	
300	330	20	30	268	298	1.4301	<b>445774</b>	1
						1.4404	<b>445775</b>	
	630	20	30	268	298	1.4301	<b>445774</b>	2
						1.4404	<b>445775</b>	
	1030	20	30	268	499	1.4301	<b>445768</b>	2
						1.4404	<b>445769</b>	
	1530	20	30	268	499	1.4301	<b>445768</b>	3
						1.4404	<b>445769</b>	
	2030	20	30	268	499	1.4301	<b>445768</b>	4
						1.4404	<b>445769</b>	
	3030	20	30	268	499	1.4301	<b>445768</b>	6
						1.4404	<b>445769</b>	

**Order information - Load class M 125**

Channel dimension		Grating dimension				Material	Item number	Quantity to fill channel
Wo [mm]	Lo [mm]	Frame height E [mm]	Bar height G [mm]	Width [mm]	Length [mm]			
200	530	20	30	168	499	1.4301	<b>445758</b>	1
						1.4404	<b>445759</b>	
	830	20	30	168	398	1.4301	<b>445764</b>	2
						1.4404	<b>445765</b>	
	1030	20	30	168	499	1.4301	<b>445758</b>	2
						1.4404	<b>445759</b>	
	1230	20	30	168	398	1.4301	<b>445764</b>	3
						1.4404	<b>445765</b>	
	1530	20	30	168	499	1.4301	<b>445758</b>	3
						1.4404	<b>445759</b>	
	2030	20	30	168	499	1.4301	<b>445758</b>	4
						1.4404	<b>445759</b>	
300	330	20	30	268	298	1.4301	<b>445776</b>	1
						1.4404	<b>445777</b>	
	630	20	30	268	298	1.4301	<b>445776</b>	2
						1.4404	<b>445777</b>	
	1030	20	30	268	499	1.4301	<b>445770</b>	2
						1.4404	<b>445771</b>	
	1530	20	30	268	499	1.4301	<b>445770</b>	3
						1.4404	<b>445771</b>	
	2030	20	30	268	499	1.4301	<b>445770</b>	4
						1.4404	<b>445771</b>	
	3030	20	30	268	499	1.4301	<b>445770</b>	6
						1.4404	<b>445771</b>	

**Order information - Load class N 250**

Channel dimension		Grating dimension				Material	Item number	Quantity to fill channel
Wo [mm]	Lo [mm]	Frame height E [mm]	Bar height G [mm]	Width [mm]	Length [mm]			
200	530	20	30	168	499	1.4301	<b>445760</b>	1
						1.4404	<b>445761</b>	
	830	20	30	168	398	1.4301	<b>445766</b>	2
						1.4404	<b>445767</b>	
	1030	20	30	168	499	1.4301	<b>445760</b>	2
						1.4404	<b>445761</b>	
	1230	20	30	168	398	1.4301	<b>445766</b>	3
						1.4404	<b>445767</b>	
	1530	20	30	168	499	1.4301	<b>445760</b>	3
						1.4404	<b>445761</b>	
	2030	20	30	168	499	1.4301	<b>445760</b>	4
						1.4404	<b>445761</b>	
300	330	20	30	268	298	1.4301	<b>445778</b>	1
						1.4404	<b>445779</b>	
	630	20	30	268	298	1.4301	<b>445778</b>	2
						1.4404	<b>445779</b>	
	1030	20	30	268	499	1.4301	<b>445772</b>	2
						1.4404	<b>445773</b>	
	1530	20	30	268	499	1.4301	<b>445772</b>	3
						1.4404	<b>445773</b>	
	2030	20	30	268	499	1.4301	<b>445772</b>	4
						1.4404	<b>445773</b>	
	3030	20	30	268	499	1.4301	<b>445772</b>	6
						1.4404	<b>445773</b>	

**Accessories for ACO box channels**

**Silt baskets for ACO hygienic box channel**

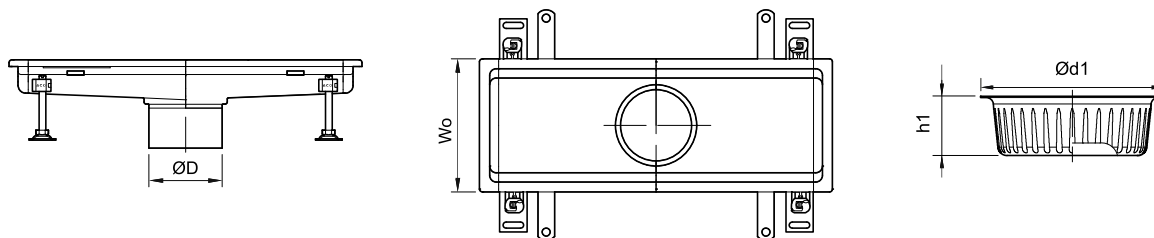

Channel dimension		Direction of gully outlet	Silt basket dimension		Capacity [l]	Material	Item number
Width Wo [mm]	Outlet ØD [mm]		Ød1 [mm]	h1 [mm]			
200, 300, 400, 500, 600, 800	125	vertical, horizontal	142	45	0.4	1.4301	<b>416900</b>
						1.4404	<b>416901</b>
200	142	vertical	142	45	0.4	1.4301	<b>416900</b>
		horizontal	142	25	0.3	1.4404	<b>416901</b>
	welded with ACO hygienic gully 142	vertical, horizontal	142	25	0.3	1.4301	<b>416902</b>
						1.4404	<b>416903</b>
300, 400, 500, 600, 800	142	vertical	159	50	0.6	1.4301	<b>416904</b>
	or					1.4404	<b>416905</b>
	welded with ACO hygienic gully 157	horizontal	159	26	0.3	1.4301	<b>416906</b>
						1.4404	<b>416907</b>
300, 400, 500, 600, 800	200	vertical	222	50	1.4	1.4301	<b>416908</b>
	or					1.4404	<b>416909</b>
	welded with ACO hygienic gully 218	horizontal	222	26	0.7	1.4301	<b>416910</b>
						1.4404	<b>416911</b>

**ACO customized box channel**

**Product information**

The dimensions of the ACO customized box channel for concrete, tiles and resin floor can be easily specified in respect of project requirements.

- Available in 1.4301 (304) or 1.4404 (316L) grades of stainless steel, pickled and passivated
- Material thickness 1.5 mm or 2 mm
- Width – up to customer request
- Length – up to customer request
- Depth – up to customer request
- Variable shape of channel – T shape, L shape, ...
- Longitudinal slopes of the channel bottom 1-5 %
- Outlet position central or variable in longitudinal axis or eccentric outlet
- Adjustable EasyFix levelling feet
- Anchors for fixing in concrete
- Protective cover available for recommended channel widths. See page 224 for more details

**Instruction**

- Please define channel dimensions by filling out required entry fields.
  - For technical support, please contact [customerservice@aco.cz](mailto:customerservice@aco.cz)
  - For Industrial Drainage information, visit [ACO Building Drainage](#) web
- Yellow entry fields highlight hygienic design options
- White entry fields highlight non-hygienic design options

**Step 1 - Material**

- Stainless steel grade 1.4301 (AISI 304)       Stainless steel grade 1.4404 (AISI 316L)

**Step 2 - Edge profile**



**Standard edge**

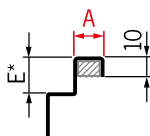

**Edge infill type**

- Rubber edge infill
- Steel edge infill
- No edge infill

**Edge width (A)**

- 15 mm
- Custom:  \*\* mm

**Extended edge**

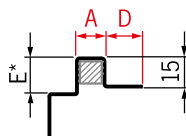

**Edge infill type**

- Rubber edge infill
- Steel edge infill
- No edge infill

**Edge width (A)**

- 15 mm
- Custom:  \*\* mm

**Flange length (D)**

- 50 mm
- Custom:  mm

**L-profile edge**

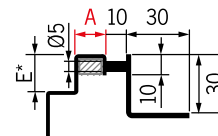

**Edge infill type**

- Rubber edge infill
- Steel edge infill
- No edge infill

**Edge width (A)**

- 15 mm
- Custom:  \*\* mm

\* Sitting height for gratings (E) is defined in step 7  
\*\* For hygienic solution, check with technical support

**Step 2 - Edge profile**

**Folded edge**

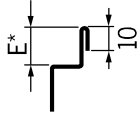

**Folded edge with flange**

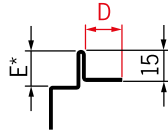

**Vinyl edge**

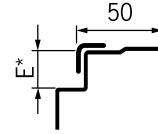

**Flange length (D)**

50 mm

Custom:  mm

**Step 3 - Channel dimensions**

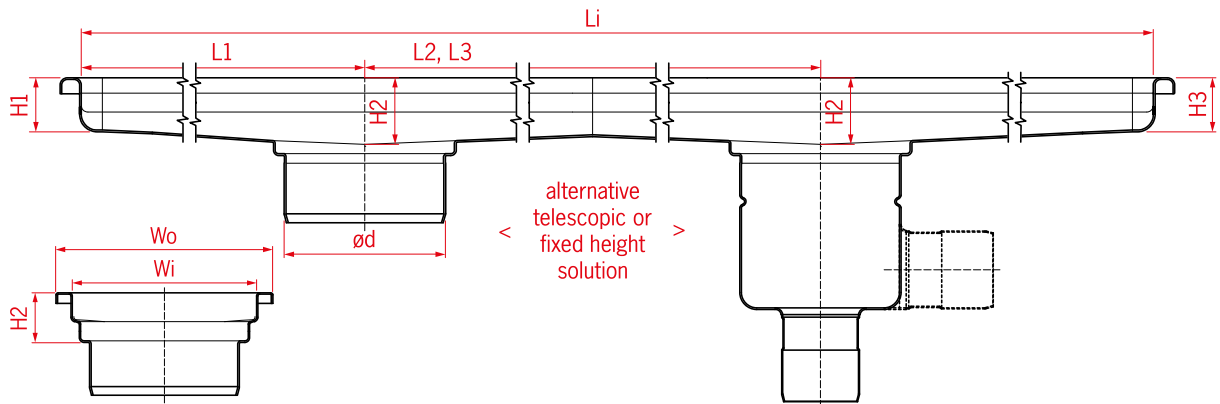

**Width**  
 Overall (Wo) / Internal (Wi)

200 mm / 170 mm  
 (valid for edge width 15 mm)

300 mm / 270 mm  
 (valid for edge width 15 mm)

400 mm / 370 mm  
 (valid for edge width 15 mm)

500 mm / 470 mm  
 (valid for edge width 15 mm)

600 mm / 570 mm  
 (valid for edge width 15 mm)

800 mm / 770 mm  
 (valid for edge width 15 mm)

Custom:  
 (For channel with standard edge width of 15 mm subtract 30 mm from overall width as value for internal width)

Wo:  mm

Wi:  mm

**Channel height at outlet (H2)**

mm

**Slope**

No

Yes - 1%

Yes - height defined  
 (If you require values below 50 mm, please contact technical support)

H1:  mm

H3:  mm

**Channel Length (Li)**

mm

**Number of outlets and their spacing (L1, L2, L3, L4)**

L1:  mm

L2:  mm

L3:  mm

L4:  mm

For higher number of outlets, please contact technical support

**Step 4 - Gully construction**

**Welded gully**

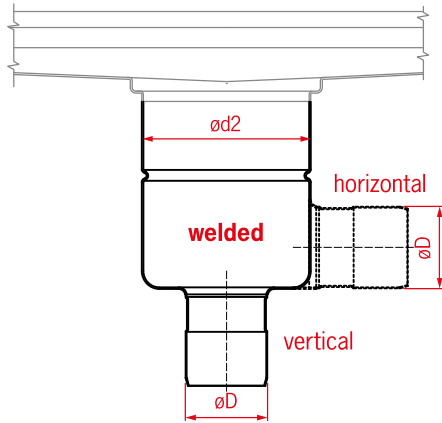

**Telescopic gully**

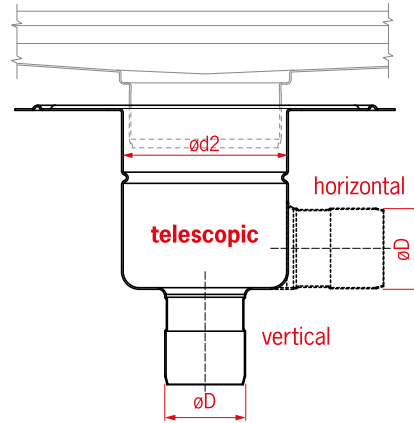

**Outlet orientation and dimensions**

Vertical outlet ( $\varnothing d2$ / $\varnothing D$ )	Horizontal outlet ( $\varnothing d2$ / $\varnothing D$ )
<input type="checkbox"/> 142 / 75 (1.4 l/s)	<input type="checkbox"/> 142 / 75 (1.4 l/s)
<input type="checkbox"/> 142 / 110 (1.6 l/s)	<input type="checkbox"/> 142 / 110 (1.6 l/s)
<input type="checkbox"/> 157 / 75 (2.7 l/s)	<input type="checkbox"/> 157 / 75 (2.6 l/s)
<input type="checkbox"/> 157 / 110 (3.5 l/s)	<input type="checkbox"/> 157 / 110 (2.8 l/s)
<input type="checkbox"/> 218 / 110 (5.0 l/s)	<input type="checkbox"/> 218 / 110 (4.4 l/s)
<input type="checkbox"/> 218 / 160 (5.0 l/s)	

**Location flange**  
(For telescopic gully only)



**Bonding flange**  
(For telescopic gully only)



**Mechanical clamping flange**  
(For telescopic gully only)



**Without gully (outlet pipe only)**

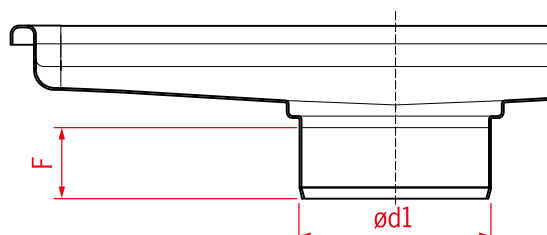

**Outlet diameter ( $\varnothing d1$ )**

- 75 mm
- 110 mm
- 125 mm
- 142 mm
- 200 mm

**Outlet length (F)**

- 36 mm
- 58 mm
- 150 mm
- Custom:  mm

**Step 5 - Accessories**

**Foul air trap included**

- Yes
- No



**Silt basket included**

- Yes
- No



**Raising piece included**

- Yes
- No
- With Location flange
- With Bonding flange
- With Mechanical clamping flange

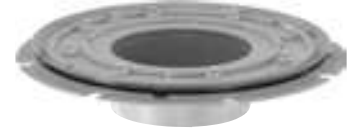

**ACO EasyFix levelling feet height (H)**

- 80 mm (standard)
- 110 mm
- 170 mm
- 200 mm
- 250 mm
- 300 mm

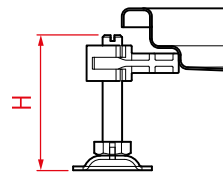

Channel with height at outlet above 200 mm are supplied with durable stainless steel levelling feet

**ACO Protective covers included**

- Yes
- No



**Step 6 - Delivery requirements**

**Maximum transport length (Lt)**

- 6000 mm (standard)
- 3000 mm
- 2000 mm

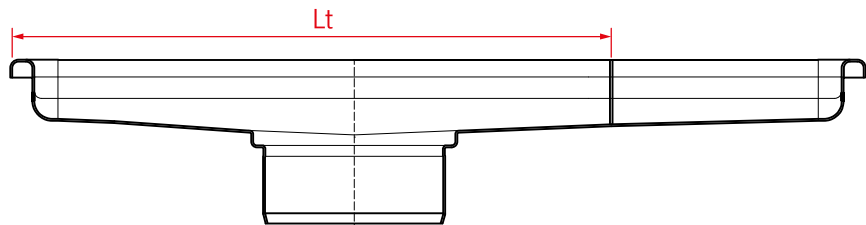

**Transport connection type**

- Welded on site
- Bolted on site



**Step 7 - Gratings**

**ACO hygienic ladder grating**

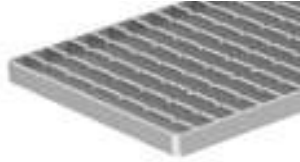

Slip resistant  Plain

**Load class**

- R 50**  
(valid up to  $W_o = 800$  mm)
- M 125**  
(valid up to  $W_o = 500$  mm)
- N 250**  
(valid up to  $W_o = 300$  mm)
- P 400**  
(Custom)

**ACO hygienic cast grating**



Slip resistant

**Load class**

- M 125** (max.  $W_o = 300$ )  
(valid up to  $W_o = 300$  mm)

**ACO mesh grating**

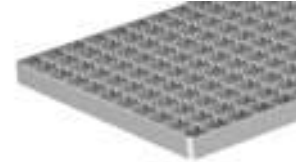

Slip resistant  Plain

**Load class**

- L 15**  
(valid up to  $W_o = 1000$  mm)
- R 50** (max.  $W_o = 300$ )  
(valid up to  $W_o = 500$  mm)
- M 125** (max.  $W_o = 300$ )  
(valid up to  $W_o = 300$  mm)

**ACO hygienic slot cover**



Slip resistant

**Load class**

- R 50**  
(valid up to  $W_o = 300$  mm)
- M 125**  
(valid up to  $W_o = 300$  mm)
- N 250**  
(valid up to  $W_o = 300$  mm)

**ACO perforated grating**

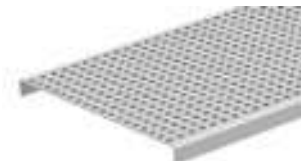

Plain

**Load class**

- L 15**  
(valid up to  $W_o = 300$  mm)
- R 50** (max.  $W_o = 300$ )  
(valid up to  $W_o = 300$  mm)

**ACO multi-slot 5 grating**

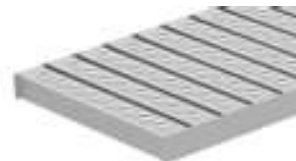

Slip resistant

**Load class**

- L 15**  
(valid up to  $W_o = 300$  mm)
- R 50** (max.  $W_o = 300$ )  
(valid up to  $W_o = 300$  mm)

**ACO heelsafe grating**



Plain

**Load class**

- L 15** (max.  $W_o = 300$ )  
(valid up to  $W_o = 300$  mm)

**Without gratings**

**Height of gratings (E)**

- 20 mm
- 25 mm
- 30 mm
- 40 mm

